

Westfields Drive

Bootle, L20

£255,000



- Click video for key facts
- Selling the **FACTS** not the **FLOWER**
- 4 Bedroom detached house
 - Detached garage
 - 2 Reception rooms
 - Utility rooms



97 | SOUTH ROAD | WATERLOO | L22 0LR
Tel: 0151 920 2404
E-mail: info@logicstates.co.uk



Ground Floor

Approx. 73.7 sq. metres (793.3 sq. feet)

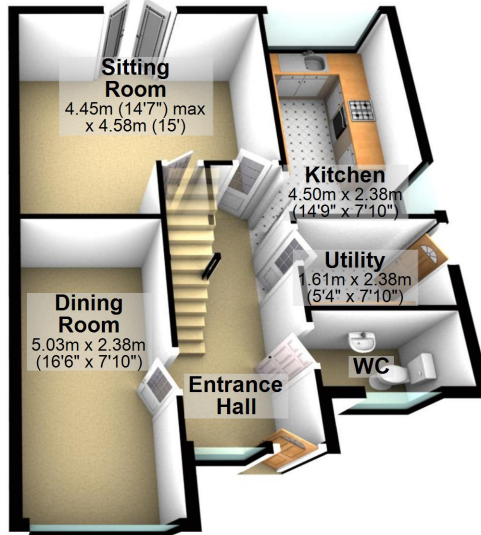

First Floor

Approx. 55.2 sq. metres (593.9 sq. feet)

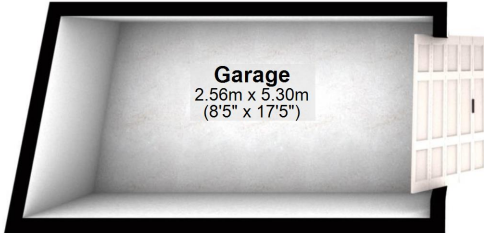
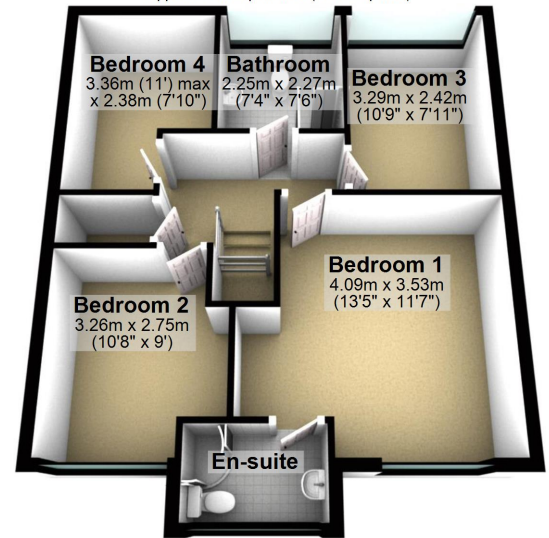

Total area: approx. 128.9 sq. metres (1387.2 sq. feet)

These particulars do not form part of any offer or contract and must not be relied upon as statements or representations of fact. Any areas, measurements or distances are approximate. The text, photographs and plans are for guidance only and are not necessarily comprehensive. It should not be assumed that the property has all the necessary planning, building regulation or other consents and we have not tested services, equipment or facilities. Purchasers must satisfy themselves by inspection or otherwise.



SELLING THE FACTS NOT THE FLOWER!

Local Authority - Sefton Council

Council Tax - Band D
Annual Price: £2,042.49

Mobile coverage
EE - Good
Vodafone - Great
O2 - Great

Broadband
Basic 16 Mbps
Superfast 80 Mbps

Satellite / Fibre TV Availability
BT - Great
Sky - Great

(Data sourced from Sprift)

'UNUSUALLY GOOD AT WHAT WE DO'

Buy, Sell or Let with the agent of the decade - Zoopla customer excellence award 2020

These particulars do not form part of any offer or contract and must not be relied upon as statements or representations of fact. Any areas, measurements or distances are approximate. The text, photographs and plans are for guidance only and are not necessarily comprehensive. It should not be assumed that the property has all the necessary planning, building regulation or other consents and we have not tested services, equipment or facilities. Purchasers must satisfy themselves by inspection or otherwise.