

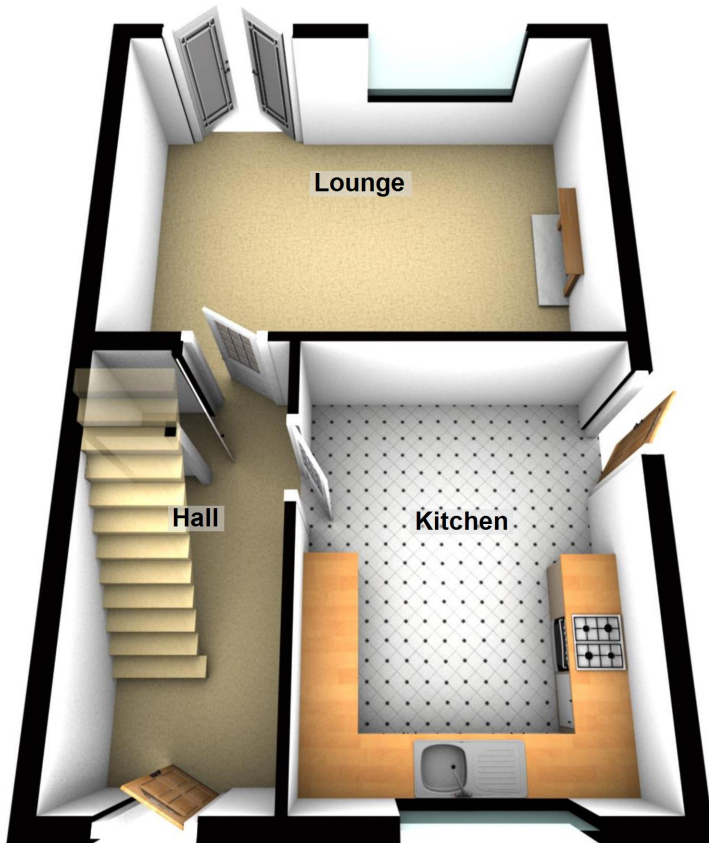

- BOOK A VIEWING ONLINE NOW. VISIT www.logicstates.co.uk
- Three Bedroom End Terrace House
- Rear Garden
- Driveway
- Gas Centrally Heated
- Double Glazed



Ground Floor



First Floor

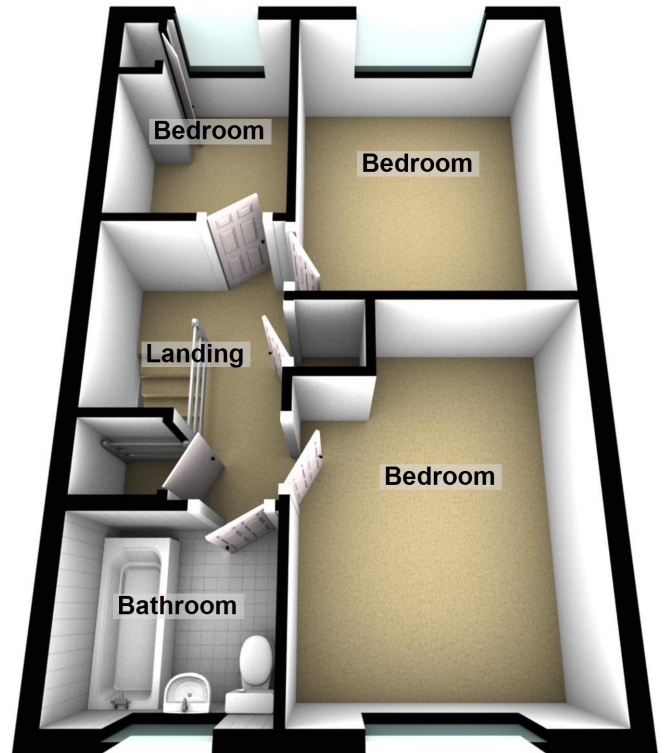

Collins Close, Bootle

These particulars do not form part of any offer or contract and must not be relied upon as statements or representations of fact. Any areas, measurements or distances are approximate. The text, photographs and plans are for guidance only and are not necessarily comprehensive. It should not be assumed that the property has all the necessary planning, building regulation or other consents and we have not tested services, equipment or facilities. Purchasers must satisfy themselves by inspection or otherwise.



Energy Efficiency Rating		
	Current	Potential
Very energy efficient - lower running costs		
(92-100) A		
(81-91) B		
(69-80) C		
(55-68) D		
(39-54) E		
(21-38) F		
(1-20) G		
Not energy efficient - higher running costs		
	71	85
England, Scotland & Wales EU Directive 2002/91/EC		

Environmental Impact (CO ₂) Rating		
	Current	Potential
Very environmentally friendly - lower CO ₂ emissions		
(92-100) A		
(81-91) B		
(69-80) C		
(55-68) D		
(39-54) E		
(21-38) F		
(1-20) G		
Not environmentally friendly - higher CO ₂ emissions		
	69	83
England, Scotland & Wales EU Directive 2002/91/EC		

Logic Are Offering For Sale This Three Bedroom End Terrace House

To Comprise;

Ground Floor:

Entrance Hall - 13'0" x 5'8"

Lounge - 16'1" x 11'3"

Kitchen - 13'0" x 9'8"

First Floor:

Bedroom One - 13'0" x 9'4"

Bedroom Two - 11'6" x 9'4"

Bedroom Three - 6'4" x 8'5"

Bathroom - 6'4" x 5'9"

Exterior:

Rear Garden

Driveway

To View Call Logic.

BOOK A VIEWING ONLINE NOW. VISIT www.logicstates.co.uk

Investment Data:

Rent = £475 pcm (approximate rent achievable)

Gross Yield = 7.1% (approximate yield based on purchase at the asking price)

These particulars do not form part of any offer or contract and must not be relied upon as statements or representations of fact. Any areas, measurements or distances are approximate. The text, photographs and plans are for guidance only and are not necessarily comprehensive. It should not be assumed that the property has all the necessary planning, building regulation or other consents and we have not tested services, equipment or facilities. Purchasers must satisfy themselves by inspection or otherwise.

97 | SOUTH ROAD | WATERLOO | L22 0LR

Tel: 0151 920 2404

E-mail: info@logicstates.co.uk

