

## WINDSOR COURT, Golders Green Road, GOLDERS GREEN, NW11 Offers in excess of £450,000



**SOLD!!! SOLD!!! SOLD BY DREAMVIEW ESTATES**

A LARGE, 2 DOUBLE BEDROOM FLAT ON 3RD FLOOR IN THIS WELL KNOWN PURPOSE BUILT BLOCK OF FLATS IN GOLDERS GREEN.

THE FLAT HAS A MODERN KITCHEN, SEPARATE LIVING ROOM AND 2 SPACIOUS BEDROOMS 1 WITH BUILT IN CUPBOARDS.

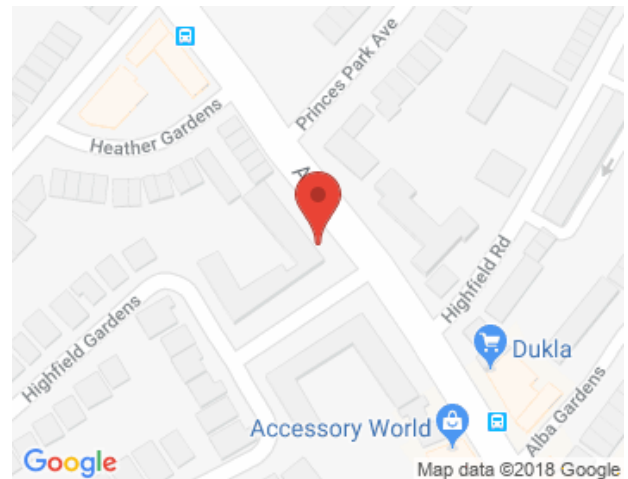



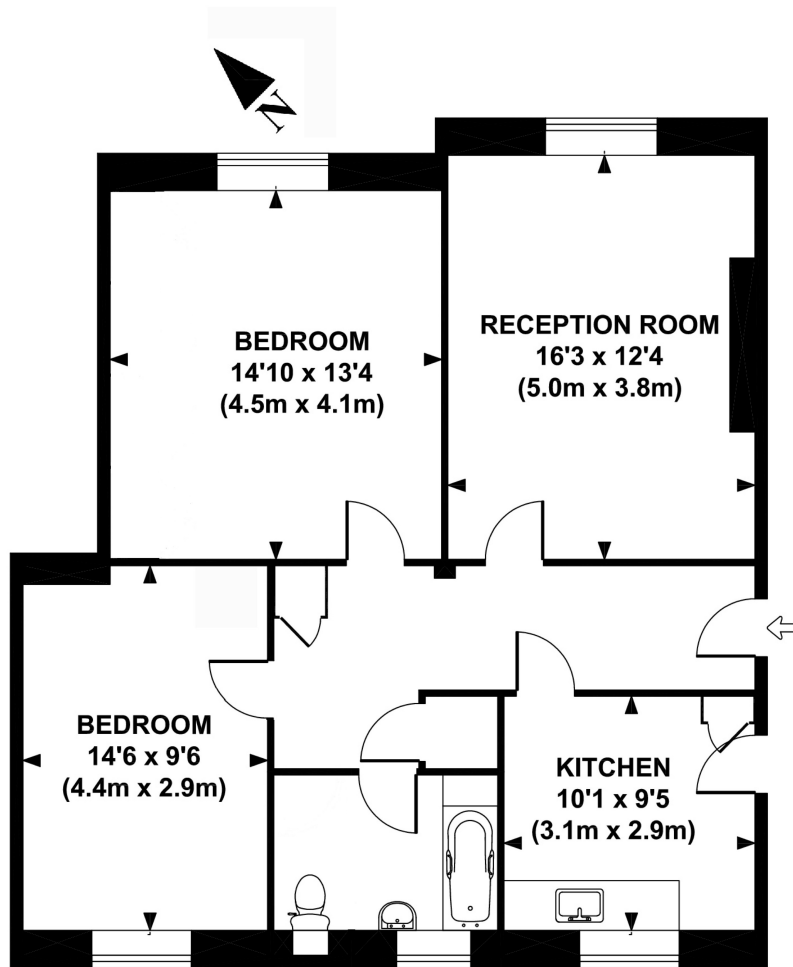

**THIRD FLOOR  
GROSS INTERNAL  
FLOOR AREA 851 SQ FT**

**APPROX. GROSS INTERNAL FLOOR AREA 851 SQ FT / 79 SQ M**

Ref: DP0264

Copyright Delph Properties 2007

This floorplan is for illustration purposes and may not truly reflect design or dimensions and should not be used for valuation or condition purposes .

Dreamview Estates give notice to anyone reading these particulars that: (i) these particulars do not constitute part of an offer or contract; (ii) these particulars and any pictures or plans represent the opinion of the author and are given in good faith for guidance only and must not be construed as statements of fact; (iii) nothing in the particulars shall be deemed a statement that the property is in good condition otherwise; we have not carried out a structural survey of the property and have not tested the services, appliances or specified fittings.

## Long Description

SOLD!!! SOLD!!! SOLD BY DREAMVIEW ESTATES

WINDSOR COURT ,GOLDERS GREEN ROAD, NW11 9PP

A SPACIOUS 2 DOUBLE BEDROOM APARTMENT SITUATED ON THE 3RD FLOOR IN THIS POPULAR PURPOSE BUILT BLOCK OF FLATS LOCATED IN THE HEART OF GOLDERS GREEN.

THE FLAT PROVIDES 2 LARGE DOUBLE BEDROOMS (WITH BUILT IN STORAGE), MODERN KITCHEN AND BATHROOM, SEPARATE LIVING ROOM AND ADDITIONAL STORAGE CUPBOARDS.

THE SERVICE CHARGES INCLUDES HEATING AND HOT WATER.

SC percentage: 2.95%

Service Charge 01.04.19 – 30.09.19 = £1313.08

Reserve Fund 01.04.19 – 30.09.19- £429.82

Service Charge 01.10.19 – 31.03.20 = £1621.09

Reserve Fund 01.10.19 – 31.03.20 = £442.50

Total yearly charge:  
£3806.49

LEASEHOLD 172 YEARS

WAS £500,000

NOW ONLY £450,000