

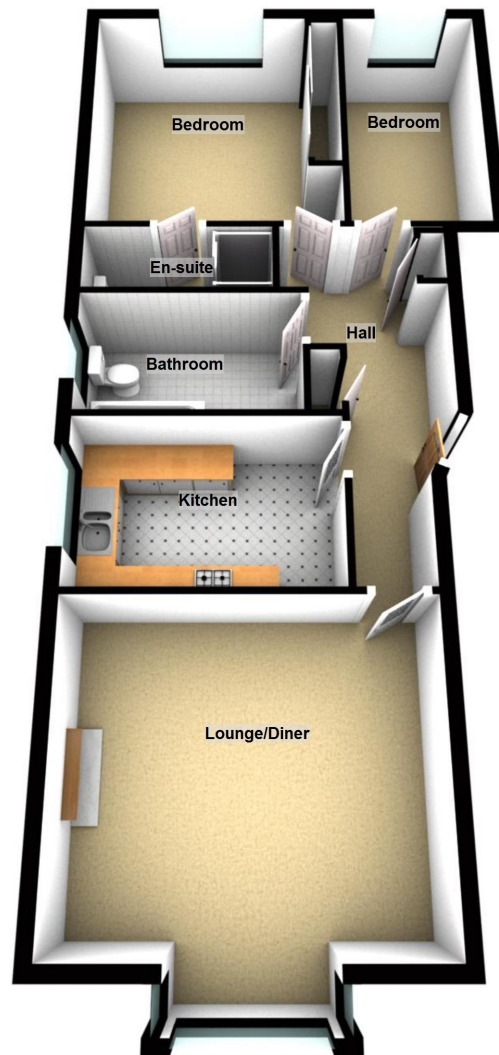

- Two Bedroom Ground Floor Flat
- Private Off Road Parking
- Communal Gardens
- Centrally Heated
- Double Glazed
- No Chain



### Ground Floor Flat



18 Abbotsford Road, Liverpool

These particulars do not form part of any offer or contract and must not be relied upon as statements or representations of fact. Any areas, measurements or distances are approximate. The text, photographs and plans are for guidance only and are not necessarily comprehensive. It should not be assumed that the property has all the necessary planning, building regulation or other consents and we have not tested services, equipment or facilities. Purchasers must satisfy themselves by inspection or otherwise.

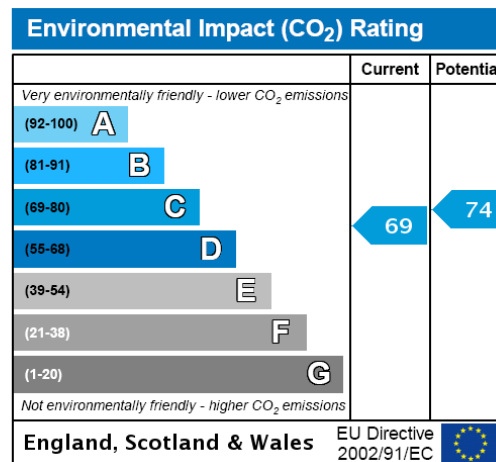
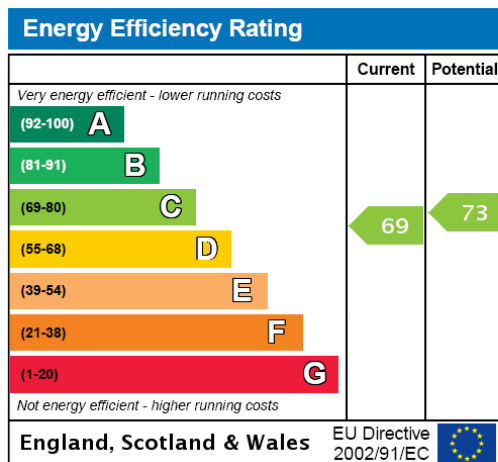

Logic Are Offering For Sale This Two Bedroom Ground Floor Flat

To Comprise;

Ground Floor:

Lounge - 15'6" x 13'5"

Kitchen - 7'6" x 11'8"

Bedroom One - 12'2" x 12'1"

En Suite - 8'7" x 3'2"

Bedroom Two - 12'4" x 6'6"

Bathroom - 5'8" x 10'1"

Exterior:

Private Off Road Parking

Communal Gardens

To View Call Logic.

These particulars do not form part of any offer or contract and must not be relied upon as statements or representations of fact. Any areas, measurements or distances are approximate. The text, photographs and plans are for guidance only and are not necessarily comprehensive. It should not be assumed that the property has all the necessary planning, building regulation or other consents and we have not tested services, equipment or facilities. Purchasers must satisfy themselves by inspection or otherwise.