

Hartwell Street
Litherland, L21

Let
£425 per month + fees



- Two Bedroom Mid Terrace House
- Open Plan Living
- Rear Yard
- Centrally Heated
- Double Glazed



97 | SOUTH ROAD | WATERLOO | L22 0LR
Tel: 0151 920 2404
E-mail: info@logicstates.co.uk



Ground Floor

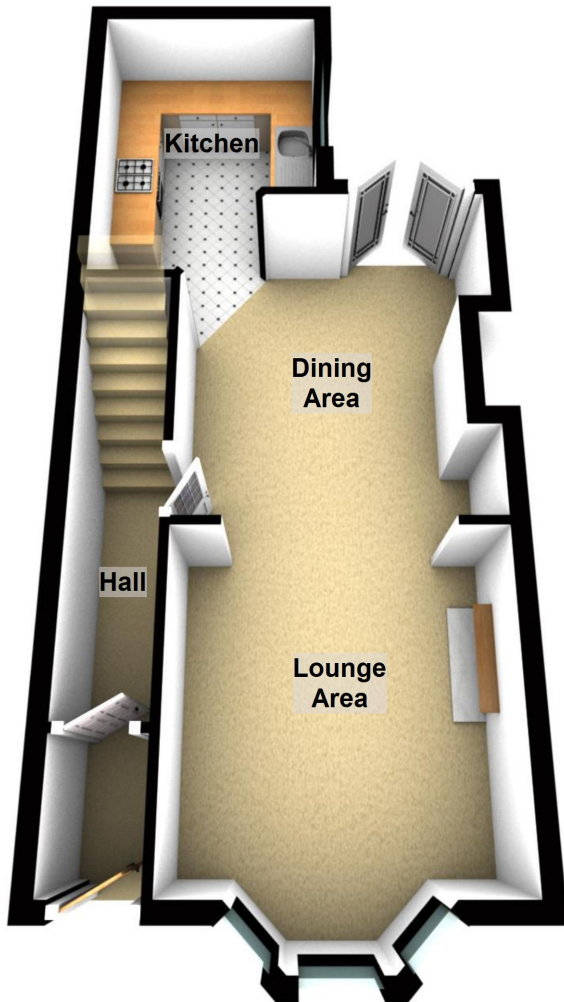

First Floor

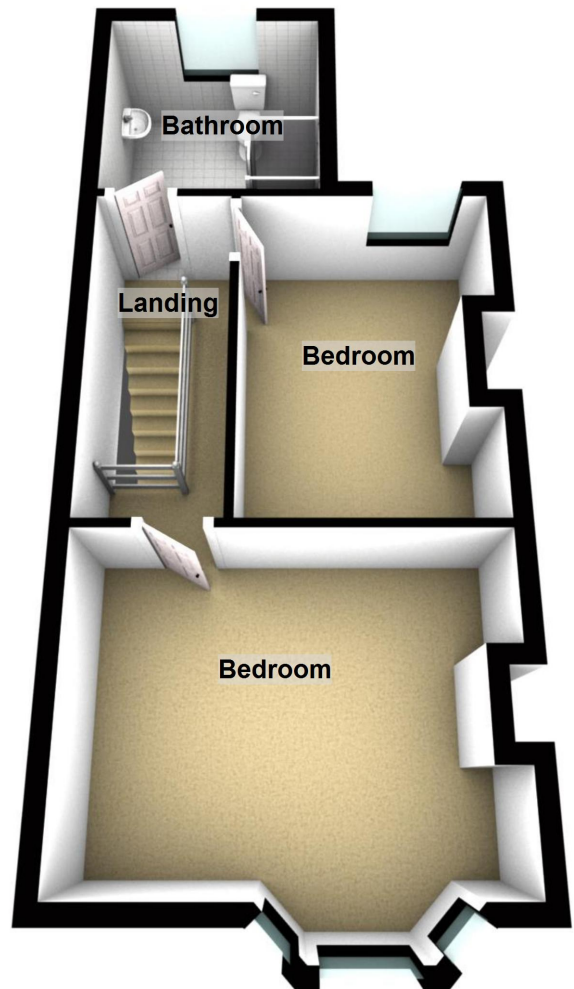

Hartwell Street, Liverpool

These particulars do not form part of any offer or contract and must not be relied upon as statements or representations of fact. Any areas, measurements or distances are approximate. The text, photographs and plans are for guidance only and are not necessarily comprehensive. It should not be assumed that the property has all the necessary planning, building regulation or other consents and we have not tested services, equipment or facilities. Purchasers must satisfy themselves by inspection or otherwise.

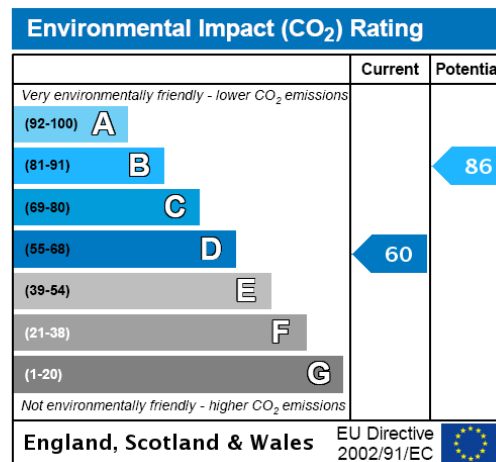
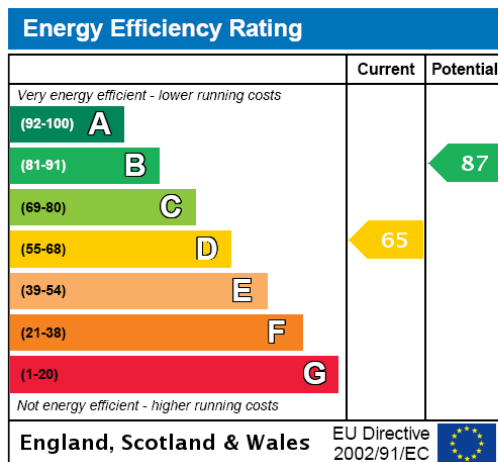

Logic Are Offering For Rent This Two Bedroom Mid Terrace House

To Comprise;

Ground Floor:

Entrance Hall

Lounge - 10'6" x 10'2"

Kitchen - 9'7" x 12'1"

Dining Area - 8'0" x 10'5"

First Floor:

Bedroom One - 10'0" x 12'7"

Bedroom Two - 9'0" x 12'1"

Bathroom - 7'3" x 8'3"

Exterior:

Rear Yard

To View Call Logic.

These particulars do not form part of any offer or contract and must not be relied upon as statements or representations of fact. Any areas, measurements or distances are approximate. The text, photographs and plans are for guidance only and are not necessarily comprehensive. It should not be assumed that the property has all the necessary planning, building regulation or other consents and we have not tested services, equipment or facilities. Purchasers must satisfy themselves by inspection or otherwise.