

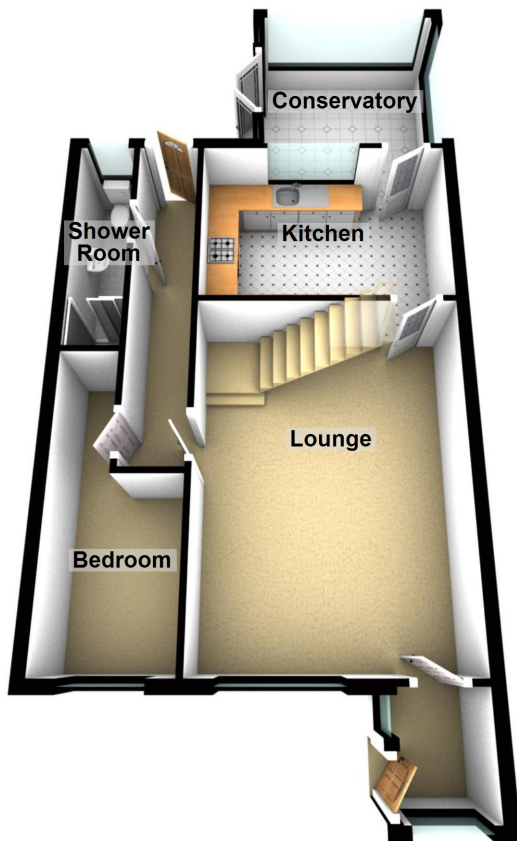

- Three Bedroom Extended Semi Detached House
- Ground Floor Bathroom With Shower
- Conservatory
- Front And Rear Gardens
- Driveway
- Cul-de-sac



Ground Floor



First Floor

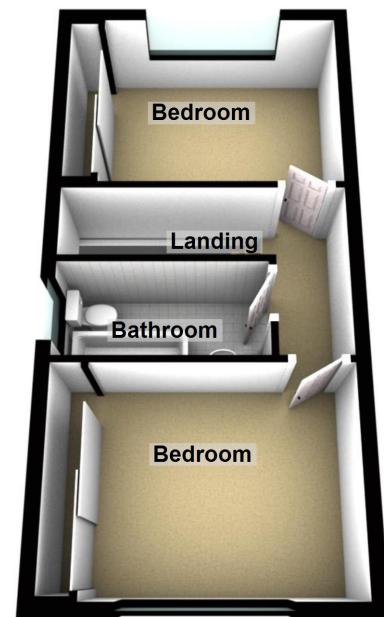

Deepdale Road, Liverpool

These particulars do not form part of any offer or contract and must not be relied upon as statements or representations of fact. Any areas, measurements or distances are approximate. The text, photographs and plans are for guidance only and are not necessarily comprehensive. It should not be assumed that the property has all the necessary planning, building regulation or other consents and we have not tested services, equipment or facilities. Purchasers must satisfy themselves by inspection or otherwise.

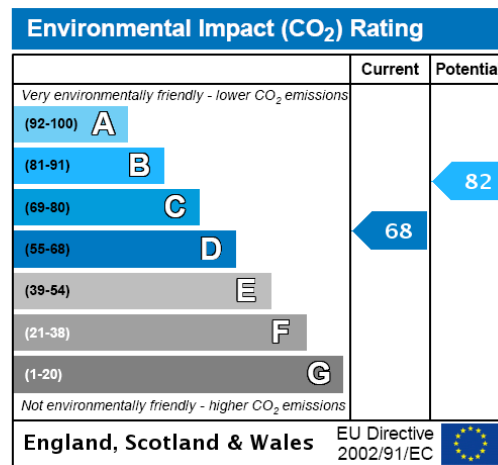
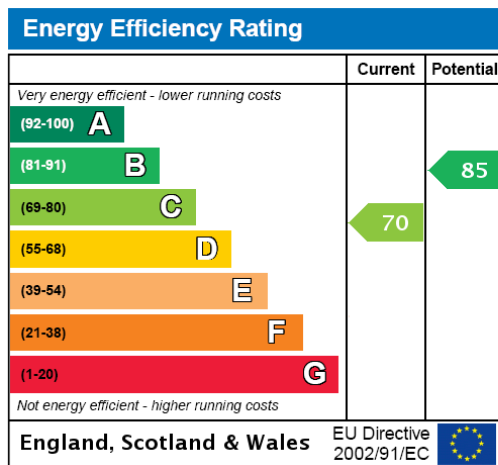

Logic Are Offering For Sale This This EXTENDED THREE BEDROOM Semi Detached House

To Comprise;

Ground Floor:

Entrance Hall - 4'8" x 4'6"

Lounge - 12'9" x 17'4"

Bathroom With Shower - 10'8" x 2'8"

Kitchen - 12'9" x 8'9"

Conservatory - 9'7" x 8'7"

Bedroom One - 8'9" x 6'3"

First Floor:

Bedroom Two - 10'9" x 9'0"

Bedroom Three - 10'9" x 9'4"

Bathroom - 8'7" x 4'6"

Exterior:

Front And Rear Garden

Driveway

To View Call Logic.

These particulars do not form part of any offer or contract and must not be relied upon as statements or representations of fact. Any areas, measurements or distances are approximate. The text, photographs and plans are for guidance only and are not necessarily comprehensive. It should not be assumed that the property has all the necessary planning, building regulation or other consents and we have not tested services, equipment or facilities. Purchasers must satisfy themselves by inspection or otherwise.