



MOUNT STREET

MAYFAIR



A superb and rarely available three double bedroom lateral first floor apartment with extensive entertaining space on one of Mayfair's most coveted Streets.

£2,500 per week PLUS FEES
UNFURNISHED

WETHERELL

MAYFAIR'S FINEST PROPERTIES

102 Mount Street · London · W1K 2TH
T: 020 7529 5588 E: rentals@wetherell.co.uk
wetherell.co.uk



NO-ONE KNOWS MAYFAIR BETTER THAN WETHERELL

1982-2012



MOUNT STREET MAYFAIR



HIGH CEILINGS • CONTEMPORARY FINISH • PRIME MAYFAIR LOCATION

NO-ONE KNOWS MAYFAIR BETTER THAN WETHERELL





MOUNT STREET MAYFAIR

A superb and rarely available three double bedroom lateral first floor apartment with extensive entertaining space on one of Mayfair's most coveted Streets.

Spanning 2,174 square feet this property has been finished to a very high standard and includes luxury fitted bathrooms (with integrated televisions), Balhaup kitchen, high ceilings, underfloor heating, Lutron lighting and built in speakers throughout.

Mount Street is the epicentre of Mayfair Village, the most sought after area of Mayfair, due to its gardens, luxury retail boutiques and famous restaurants.

- * Double Reception
- * Three Double Bedrooms all en Suite
- * Balhaup Kitchen
- * Luxury Bathrooms with integrated Televisions
- * Contemporary Finish
- * First Floor with Lift
- * High Ceilings
- * Lutron Lighting
- * Underfloor Heating
- * Built in Speakers Throughout
- * Prime Mayfair Address
- * Unfurnished
- * 2174sq.ft.

* Tenant Fees Apply - £240.00 inclusive of VAT is payable by the Tenant for Wetherell conducting tenant checks, credit checks and drawing up a tenancy agreement. Cost is payable per unit dwelling.



£2,500 per week PLUS FEES

UNFURNISHED

Wetherell have no authority to make or give any representations or warranties in relation to the property. These particulars do not form part of any offer or contract and must not be relied upon as statements or representations of fact. Any areas, measurements or distances are approximate. The text, photographs and plans are for guidance only and are not necessarily comprehensive. It should not be assumed that the property has all the necessary planning, building regulation or other consents and Wetherell have not tested any services, equipment or facilities. Purchasers must satisfy themselves by inspection or otherwise. 2018

WETHERELL
MAYFAIR'S FINEST PROPERTIES

102 Mount Street · London · W1K 2TH
T: 020 7529 5588 E: rentals@wetherell.co.uk
wetherell.co.uk



1982-2012

NO-ONE KNOWS MAYFAIR BETTER THAN WETHERELL



MOUNT STREET MAYFAIR

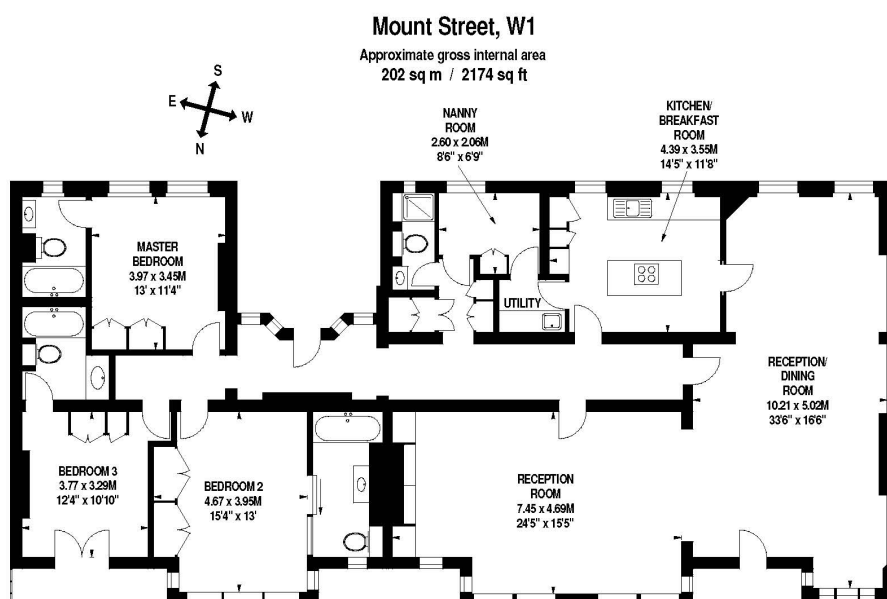

First Floor

Floorplan produced for Wetherell by Mays Floorplans. ©. Tel 020 3397 4594
Illustration for identification purposes only, not to scale
All measurements are maximum, and include wardrobes and window bays where applicable

Wetherell have no authority to make or give any representations or warranties in relation to the property. These particulars do not form part of any offer or contract and must not be relied upon as statements or representations of fact. Any areas, measurements or distances are approximate. The text, photographs and plans are for guidance only and are not necessarily comprehensive. It should not be assumed that the property has all the necessary planning, building regulation or other consents and Wetherell have not tested any services, equipment or facilities. Purchasers must satisfy themselves by inspection or otherwise. 2018

WETHERELL

MAYFAIR'S FINEST PROPERTIES

102 Mount Street · London · W1K 2TH
T: 020 7529 5588 E: rentals@wetherell.co.uk
wetherell.co.uk



1982-2012

NO-ONE KNOWS MAYFAIR BETTER THAN WETHERELL