

To find out more please call us on **020 8549 3366**

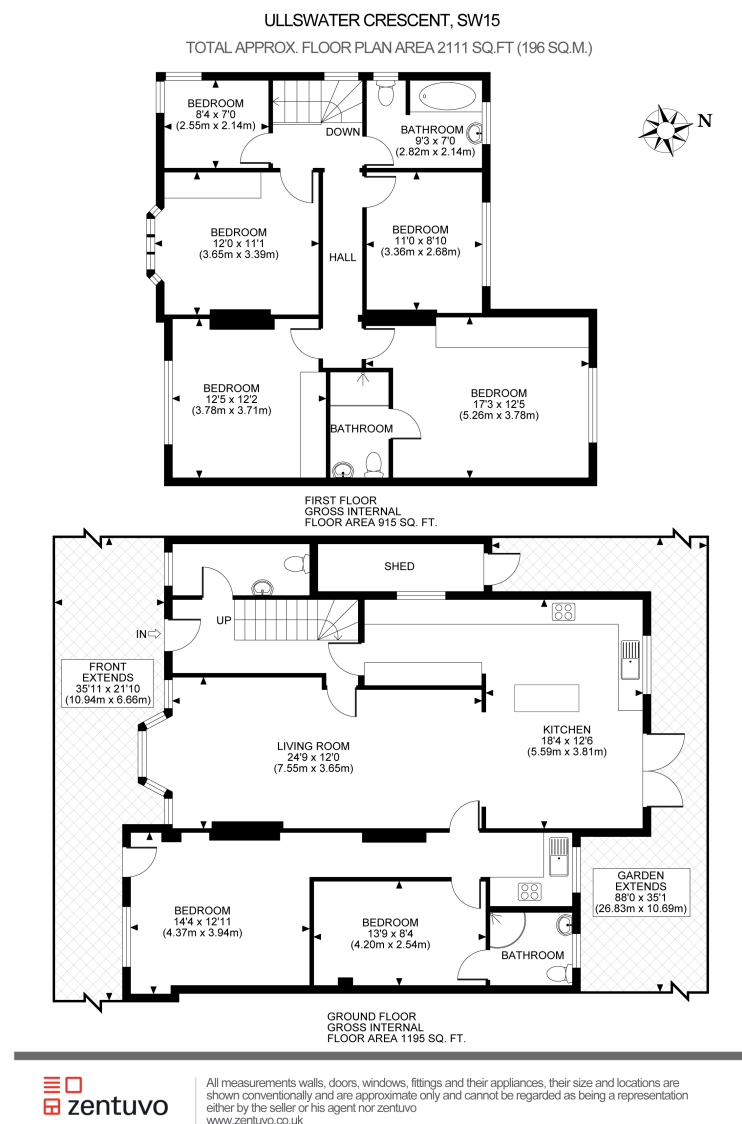

ULLSWATER CRESCENT



RENTAL £3,150 per month + fees

STATEMENT OF INTENT

- We are independent property marketing experts dedicated to finding you a new home.
- We are agile & responsive to your search requirements. We listen and won't waste time recommending properties outside your search criteria. If we don't have your perfect property we'll market and advertise on your behalf.
- We provide a dedicated point-of-contact who'll listen to what's important in your property search from viewing through to exchange and final completion.



Kingston Hill | North Kingston
020 8549 3366 | **020 8549 7788**
mail@carringtonsproperty.com
www.carringtonsproperty.co.uk



www.carringtonsproperty.co.uk

ULLSWATER CRESCENT



Detached house in the popular Ullswater Crescent, with six bedrooms and two en suite shower rooms as well as parking for up to three cars. Kingston Vale is located between Richmond Park and Wimbledon common, offering easy access to the A3 for Central London and simple routes towards Wimbledon or Putney.

This large home comprises a big and bright lounge with beamed ceiling, this reception opening into the modern and stylish eat-in kitchen. The property comes with a one-bedroom self-contained annex. With a private entrance, this part of the property contains a kitchenette, lounge and separate bedroom adjoining a modern shower room, perfect for relatives or lodgers requiring a self-contained space. Upstairs, in the main house, there are a further five bedrooms, family bathroom and master en suite bedroom with views of the sprawling garden below.

