

BRITTEN CLOSE, GOLDERS GREEN, NW11
£295,000, Leasehold

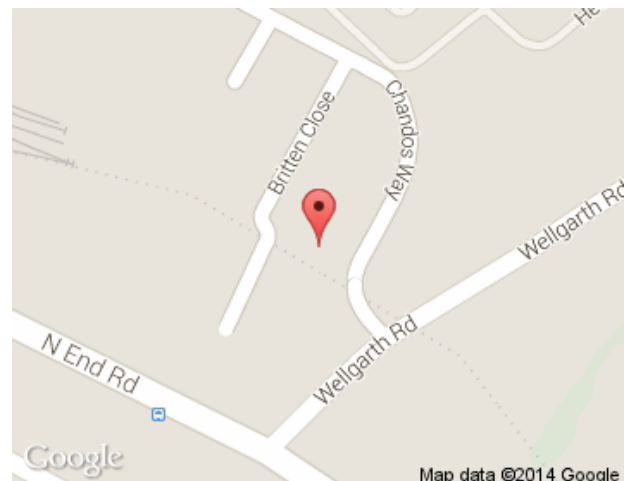

SUPERB MODERNIZED 1 BED FLAT ON 1ST FLR OF THIS POPULAR PB BLOCK NEAR GOLDERS GREEN STATION.

THE FLAT HAS BEEN COMPLETELY REFURBISHED THROUGHOUT WITH A LUXURY KITCHEN AND BRAND NEW KITCHEN WHICH IS OPEN PLAN WITH THE LOUNGE.





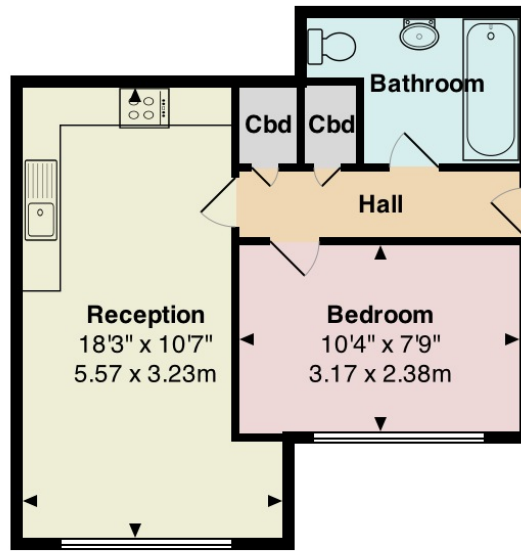

First Floor

Britten Close NW11
Total Floor Area 354 Sq Ft (32.9 Sq m)

All measurements are approximate and for display purposes only. Copyright Peninsula Surveys Ltd

Dreamview Estates give notice to anyone reading these particulars that: (i) these particulars do not constitute part of an offer or contract; (ii) these particulars and any pictures or plans represent the opinion of the author and are given in good faith for guidance only and must not be construed as statements of fact; (iii) nothing in the particulars shall be deemed a statement that the property is in good condition otherwise; we have not carried out a structural survey of the property and have not tested the services, appliances or specified fittings.

Long Description

UNDER OFFER

A SUPERB MODERNISED 1 BED FLAT ON 1ST FLOOR OF THIS POPULAR PB BLOCK NEAR GOLDERS GREEN STATION.

THE FLAT HAS BEEN RECENTLY COMPLETELY REFURBISHED THROUGHOUT WITH A LUXURY KITCHEN AND BRAND NEW KITCHEN WHICH IS OPEN PLAN WITH THE LOUNGE.
AVAILABLE 12/04/22