

To find out more please call us on **020 8549 3366**

### Kingswood House

Approximate Gross Internal Area = 950 sq ft / 88.3 sq m

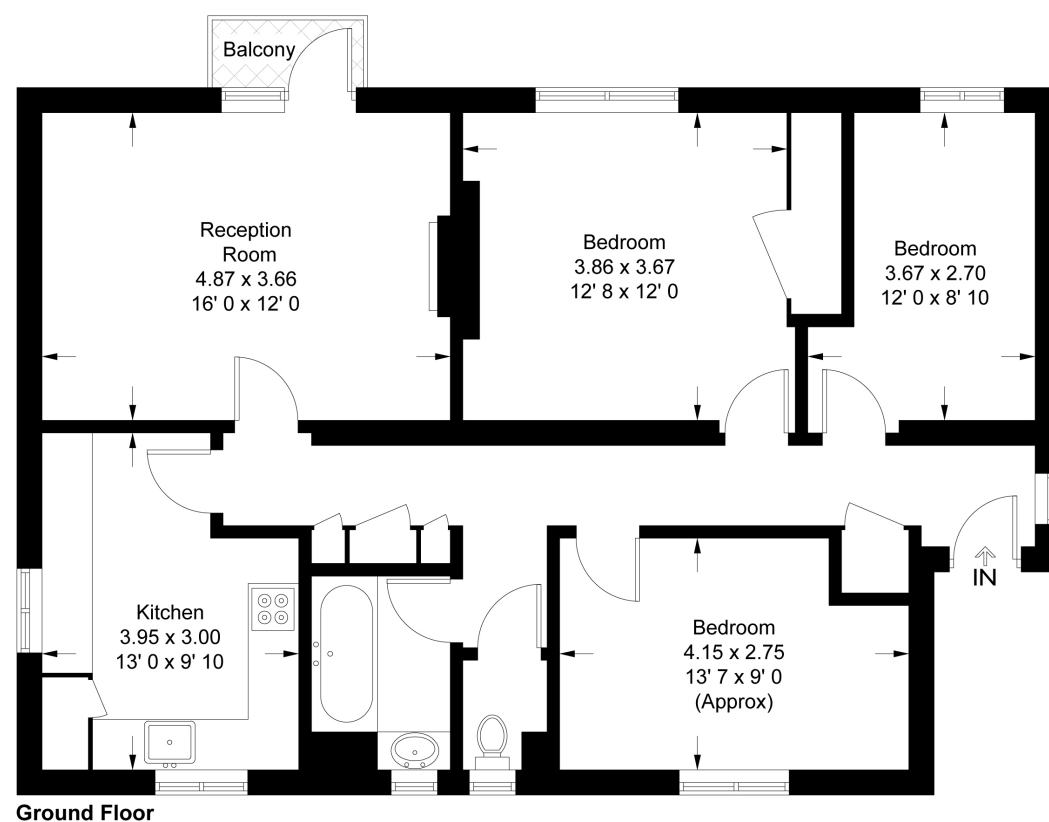

This plan is not to scale and must be used as layout guidance only. All measurements and areas are approximate and should not be relied upon to provide accurate information. This plan must not be relied upon when making property valuations, design considerations or any other such relevant decisions. We accept no responsibility or liability (whether in contract, tort or otherwise) in relation to any loss whatsoever arising from or in connection with any use of this plan or the adequacy, accuracy or completeness of it or any information within it.



£350,000

#### STATEMENT OF INTENT

- We are independent property marketing experts dedicated to finding you a new home.
- We are agile & responsive to your search requirements. We listen and won't waste time recommending properties outside your search criteria. If we don't have your perfect property we'll market and advertise on your behalf.
- We provide a dedicated point-of-contact who'll listen to what's important in your property search from viewing through to exchange and final completion.



## Carringtons

Kingston Hill  
**020 8549 3366**

mail@carringtonsproperty.com

North Kingston  
**020 8549 7788**

www.carringtonsproperty.co.uk



## Carringtons

www.carringtonsproperty.co.uk



# KINGSNYMPTON PARK



A large three bedroom ground floor flat in this popular purpose built development. The apartment is well proportioned and is ideal for buy to let investors looking for an easy and popular property to let; close to Kingston University with easy access to Norbiton Trains.

