

To find out more please call us on **020 8549 3366**

Flat 27, Cromwell Court, Kingston Hill,
Kingston upon Thames, KT2 7PY
Approximate Gross Internal Area = 86.7 sq m / 933 sq ft

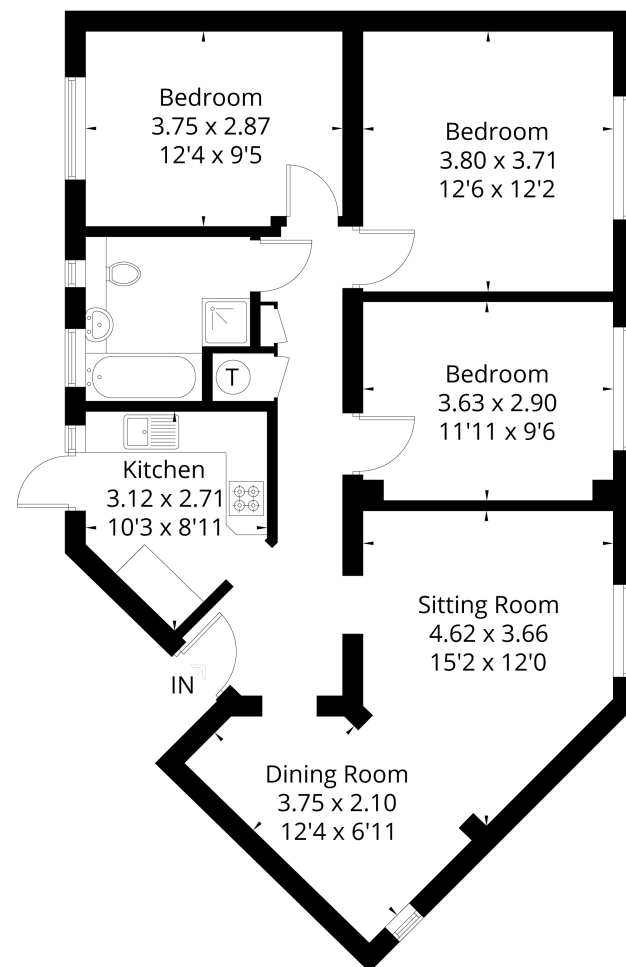

FLOORPLANZ © 2018 0203 9056099 Ref: 212089
This plan is for layout guidance only. Drawn in accordance with RICS guidelines. Not drawn to scale unless stated. Windows & door openings are approximate.
Whilst every care is taken in the preparation of this plan, please check all dimensions, shapes & compass bearings before making any decisions reliant upon them.

KINGSTON HILL



RENTAL £1,750 per month + fees

STATEMENT OF INTENT

- We are independent property marketing experts dedicated to finding you a new home.
- We are agile & responsive to your search requirements. We listen and won't waste time recommending properties outside your search criteria. If we don't have your perfect property we'll market and advertise on your behalf.
- We provide a dedicated point-of-contact who'll listen to what's important in your property search from viewing through to exchange and final completion.



Kingston Hill | North Kingston
020 8549 3366 | **020 8549 7788**
mail@carringtonsproperty.com
www.carringtonsproperty.co.uk



www.carringtonsproperty.co.uk

KINGSTON HILL



Spacious 3 double bedroom flat on Kingston Hill close walking distance to Norbiton Station, Richmond Park, Kingston Town Centre and easy access to public transport to Kingston, Wimbledon, New Malden and Kingston University.

The flat comprises 3 double bedrooms, a large reception room with a dining area, fully fitted kitchen and a bathroom with separate bath and shower. The property is fully furnished and available. 1st July 2021

