



FLAT 3
6 CHARLES
STREET
MAYFAIR W1

A RARE FIRST FLOOR
APARTMENT OF 923 SQUARE
FEET WITH CEILING HEIGHTS
OF OVER 15 FEET AND
A SOUTH FACING ORNATE
BALCONY ACCESSIBLE
FROM THREE LARGE
FRENCH WINDOWS



FLAT 3, 6 CHARLES STREET, MAYFAIR W1



One of Mayfair's most highly regarded residential streets, Charles Street is only moments away from bustling Berkeley Square, the open spaces of Green Park and the boutiques and restaurants of fashionable Mount Street.

ACCOMMODATION

- Reception Room
- Kitchen
- Bedroom
- Bathroom
- Balcony
- Lift
- 923 Sq Ft
- EPC Band: D





The apartment offers a unique opportunity for somebody who wants to put their own stamp on an apartment with huge potential to be Mayfair's premier pied-à-terre.



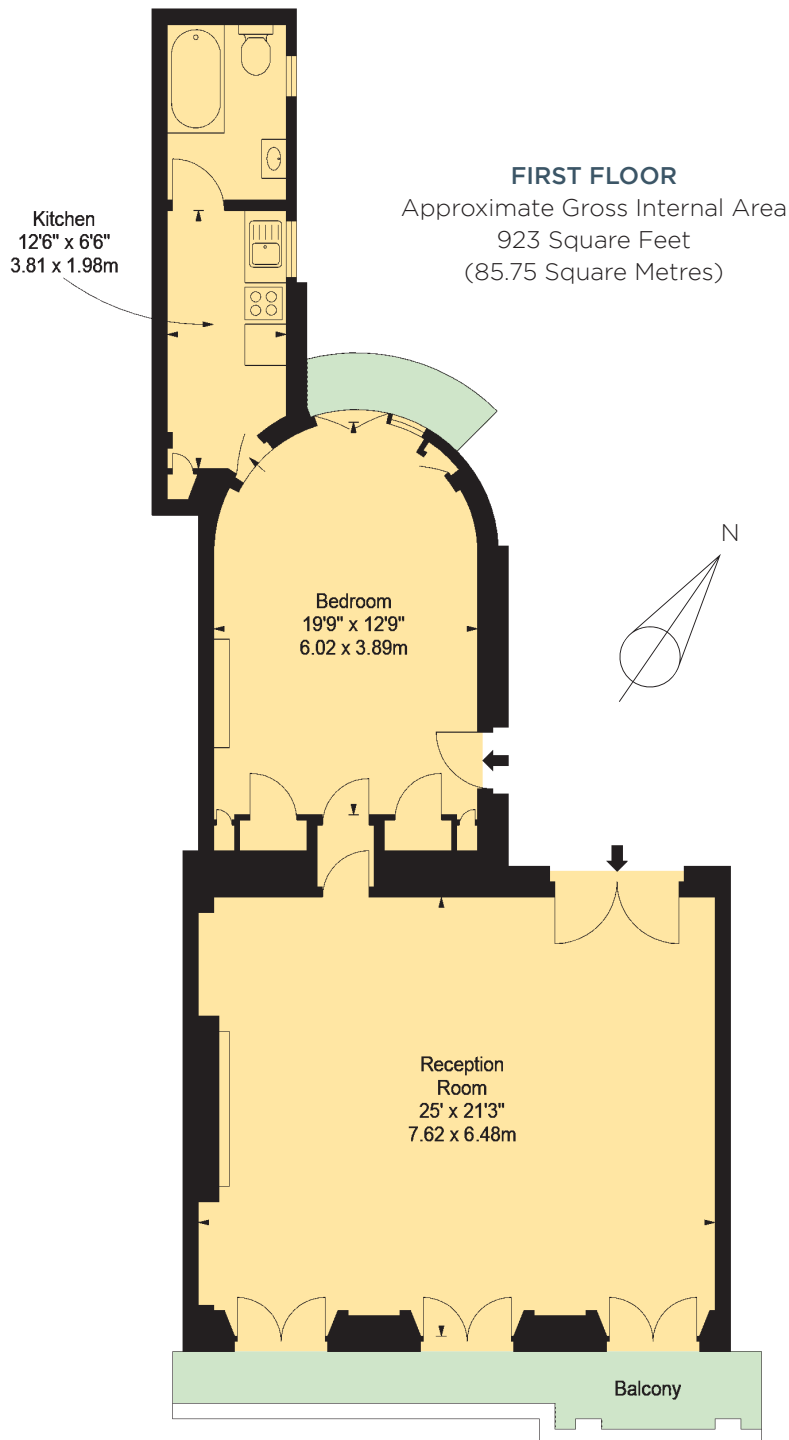

Leasehold: 15 years remaining
Service Charge: £2,004 per annum
Ground Rent: £300 per annum
Guide Price: £1,250,000

Sole Agent



102 Mount Street, London W1K 2TH

T: 020 7529 5566

E: sales@wetherell.co.uk

wetherell.co.uk

Wetherell have no authority to make or give any representations or warranties in relation to the property. These particulars do not form part of any offer or contract and must not be relied upon as statements or representations of fact. Any areas, measurements or distances are approximate. The text, photographs and plans are for guidance only and are not necessarily comprehensive. It should not be assumed that the property has all the necessary planning, building regulation or other consents and Wetherell have not tested any services, equipment or facilities. Purchasers must satisfy themselves by inspection or otherwise. Energy Efficiency Rating: Band D. October 2015