

To find out more please call us on **020 8549 3366**

Park Road, Kingston upon Thames, KT2 5LP

Approximate Gross Internal Area = 123.6 sq m / 1330 sq ft
(Including Loft)

Garage = 11.9 sq m / 128 sq ft

Total = 135.5 sq m / 1458 sq ft

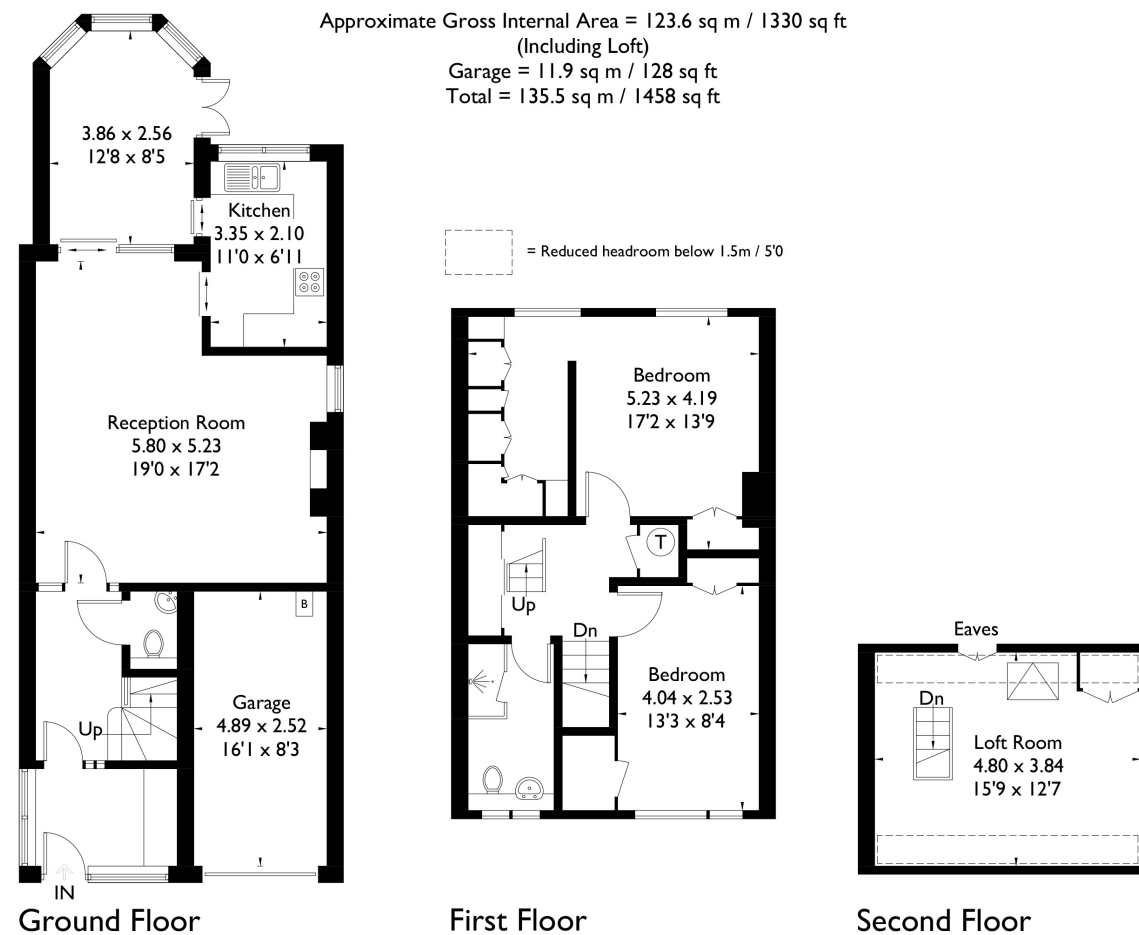

FLOORPLANZ © 2016 0845 6344080 Ref: 167665

This plan is for layout guidance only. Drawn in accordance with RICS guidelines. Not drawn to scale unless stated. Windows & door openings are approximate. Whilst every care is taken in the preparation of this plan, please check all dimensions, shapes & compass bearings before making any decisions reliant upon them.



Guide Price of £750,000, Freehold

STATEMENT OF INTENT

- We are independent property marketing experts dedicated to finding you a new home.
- We are agile & responsive to your search requirements. We listen and won't waste time recommending properties outside your search criteria. If we don't have your perfect property we'll market and advertise on your behalf.
- We provide a dedicated point-of-contact who'll listen to what's important in your property search from viewing through to exchange and final completion.



Kingston Hill | North Kingston

020 8549 3366

020 8549 7788

mail@carringtonsproperty.com

www.carringtonsproperty.co.uk



www.carringtonsproperty.co.uk

PARK ROAD



In North Kingston, very close to the historical Richmond Park is this three-bedroom end-of-terrace house. This family home is located on Park Road, for bus routes to the riverside Richmond and Kingston town centres, and for local shops and cafes, also found on the nearby Tudor Drive. A short walk away is Latchmere Recreation Ground, with the outstanding Latchmere and St Agatha's schools even closer.

This property benefits from an integral garage closing the large driveway, and from a conservatory and kitchen both overlooking the beautiful garden. Meanwhile, the large I-shaped reception room is separate from the kitchen and, upstairs, the family shower room is modern, fitted with vanity sink and large shower. All three bedrooms, including the loft-conversion, contain inbuilt wardrobe space.

