



'brook green's favourite estate agents'

**FINLAY
BREWER**

Ceylon Road, Brook Green, W14 £1,100 per week + fees, For long let



A wonderful, contemporary family home with 4 double bedrooms.

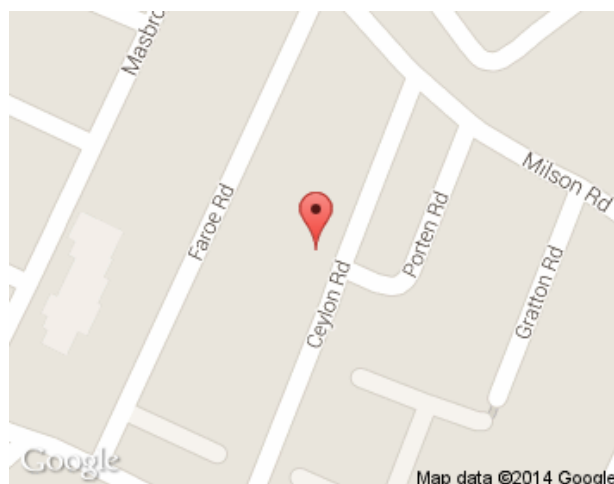



Energy Efficiency Rating		Current	Potential
Very energy efficient - lower running costs			
(92-100) A			
(81-91) B			
(69-80) C			
(55-68) D			
(39-54) E			
(21-38) F			
(1-20) G			
Not energy efficient - higher running costs			
		67	79
England, Scotland & Wales		EU Directive 2002/91/EC	

Environmental Impact (CO ₂) Rating		Current	Potential
Very environmentally friendly - lower CO ₂ emissions			
(92-100) A			
(81-91) B			
(69-80) C			
(55-68) D			
(39-54) E			
(21-38) F			
(1-20) G			
Not environmentally friendly - higher CO ₂ emissions			
		62	76
England, Scotland & Wales		EU Directive 2002/91/EC	

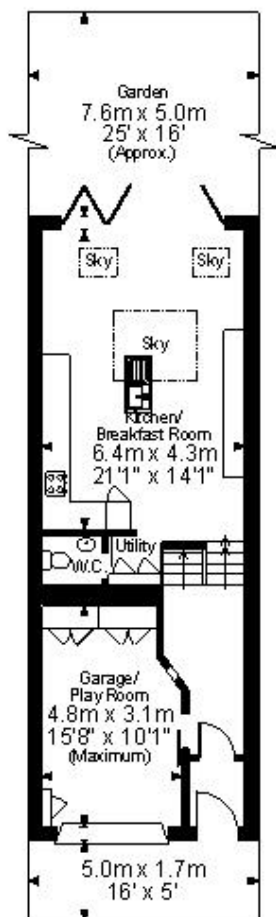

Ground Floor

Ceylon Road, W14
Approximate Gross Internal Area
Main House = 1600 Sq Ft/149 Sq M
Garage/Play Room = 145 Sq Ft/13 Sq M
Restricted Head Height = 48 Sq Ft/4 Sq M
Total = 1793 Sq Ft/166 Sq M

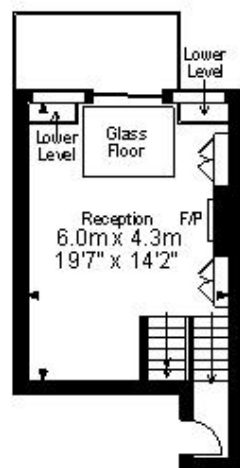
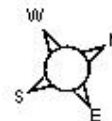

**Raised Ground Floor
(Above Kitchen)**

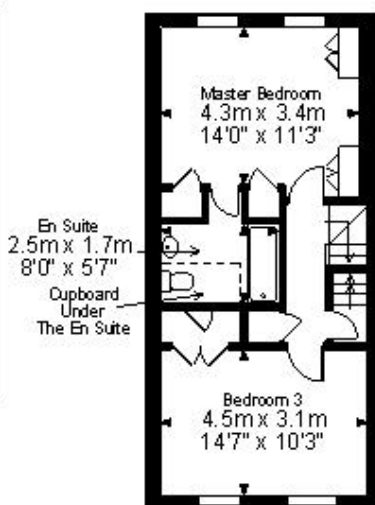

First Floor

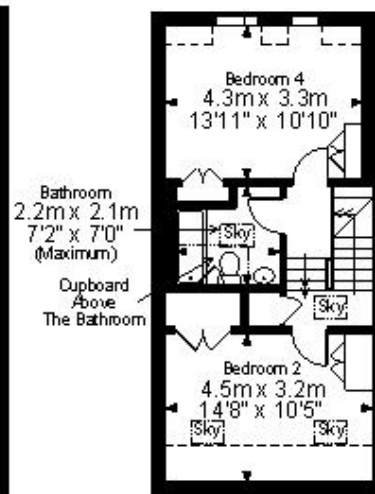

Second Floor

FOR ILLUSTRATIVE PURPOSES ONLY - NOT TO SCALE

The position & size of doors, windows, appliances and other features are approximate only.

□ □ □ □ Denotes restricted head height

© ehouse. Unauthorised reproduction prohibited. Drawing ref. dig8169803/JBN

Finlay Brewer give notice to anyone reading these particulars that: (i) these particulars do not constitute part of an offer or contract; (ii) these particulars and any pictures or plans represent the opinion of the author and are given in good faith for guidance only and must not be construed as statements of fact; (iii) nothing in the particulars shall be deemed a statement that the property is in good condition otherwise; we have not carried out a structural survey of the property and have not tested the services, appliances or specified fittings.

Long Description

A wonderful, contemporary 4 bedroom family home. The garden floor has a fabulous kitchen/breakfast/family room with glass concertina doors leading into the 25' garden. The raised ground floor has a full width sitting room with fireplace and full height and width glass sliding doors overlooking the garden. All 4 double bedrooms have built in cupboards and there are 2 bathrooms (en suite master bathroom). There is also an integral garage with under floor heating and a weather sealed door that is currently used as a playroom and storage area. Available July

Administration fee £150 inc VAT per person, other costs apply. For more information go to: www.finlaybrewer.co.uk/property-management/tenant-fees-and-costs/