



BOURDON STREET, MAYFAIR W1

A beautifully presented 2-3 bedroom period mews house in the heart of Mayfair. The internal space has recently been re-configured giving the house a light and airy contemporary feel.

£1,700 per week

Furnished



T: +44 (0) 20 7493 6935

E: mail@wetherell.co.uk

wetherell.co.uk

102 Mount Street · London · W1K 2TH







BOURDON STREET, MAYFAIR W1

* Master Bedroom * En suite Bathroom * Dressing Area * Second Double Bedroom Suite *
Bedroom Three / Study * Shower Room * Reception Room * Kitchen * Garage * Utility Room
* Terrace *



Gross Internal Area = 146 sq. metres
1578 sq. feet



SECOND FLOOR

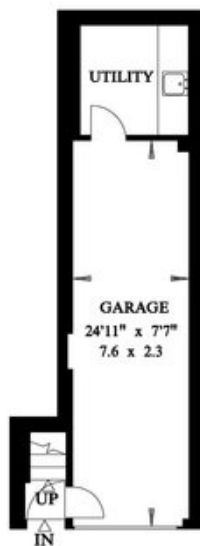

GROUND FLOOR



FIRST FLOOR