

SALTER REX

Chartered Surveyors & Estate Agents



CAVERSHAM ROAD, NW5

£475,000 LEASEHOLD

LOUNGE



CAVERSHAM ROAD, NW5

An outstanding two bedroom maisonette, forming part of a handsome Victorian semi-detached house, situated in a prime residential side turning within a short walk of Kentish Town Underground and Camden School for Girls.

The property offers a generous 805 square feet of accommodation, conveniently arranged and finished to a high standard throughout. To the rear is a stunning landscaped garden of approximately 90 feet.



BEDROOM ONE

KITCHEN



BATHROOM

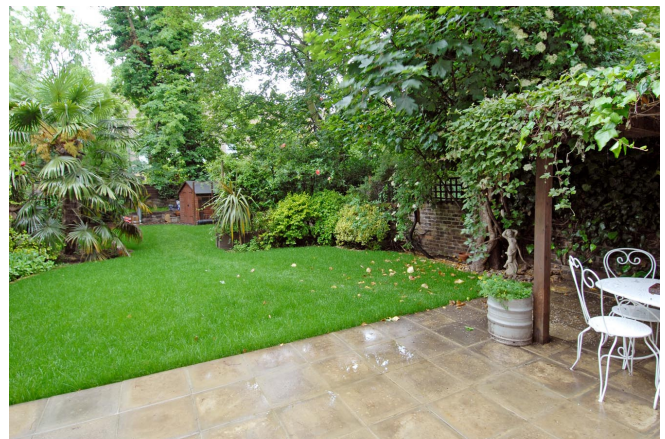

GARDEN

FLOOR PLAN

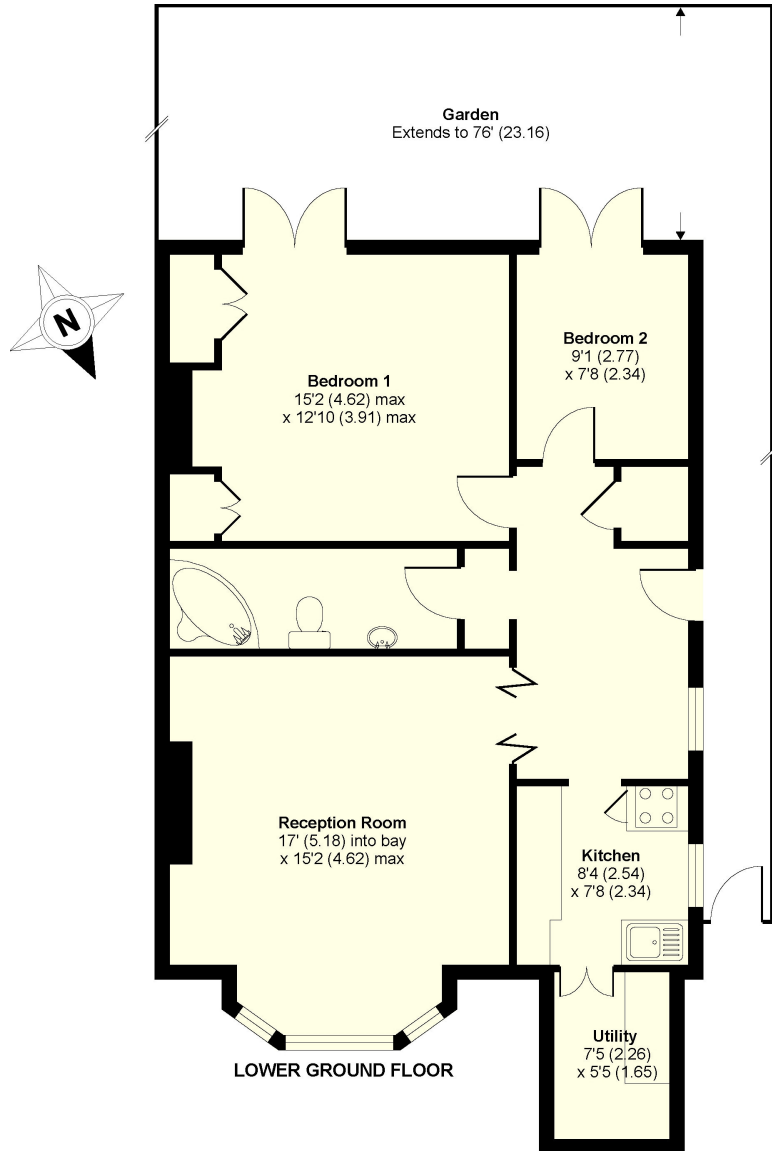

GROSS FLOOR AREA
INTERNAL 793 SQFT 73.6 SQMETRES

Caversham Road, London, NW5

ENERGY PERFORMANCE CHART

CONTACT DETAILS

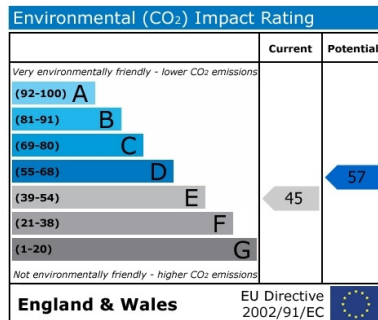
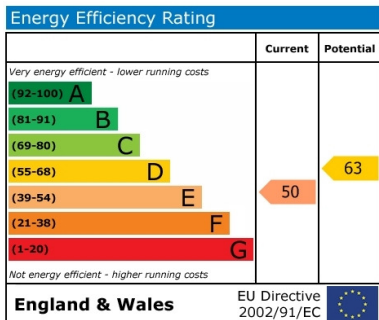

SALTER REX
Chartered Surveyors & Estate Agents

SALTER REX KENTISH TOWN
CROWN HOUSE
265-267 KENTISH TOWN ROAD
LONDON
NW5 2TP

T 020 7482 4488 F 020 7485 8488

E: residential@salter-rex.co.uk

W: www.salter-rex.co.uk