

# **SALTER REX**

**Chartered Surveyors & Estate Agents**



**LAMBLE STREET, NW5 4AS**

**£395,000 FREEHOLD**

## BEDROOM TWO



## LAMBLE STREET, NW5 4AS

A well proportioned three bedroom mid terrace house dating from the 1950's. Internally the property offers good sized accommodation throughout and benefits from an attractive rear garden. Though the property would require some refurbishment, it could easily be transformed into a wonderful family home. Lamble Street is situated within easy reach of the transport links of Gospel Oak as well as being only moments from the glorious, green open space of Hampstead Heath.



## RECEPTION

## GARDEN



**BEDROOM ONE**



**BEDROOM THREE**

# FLOOR PLAN

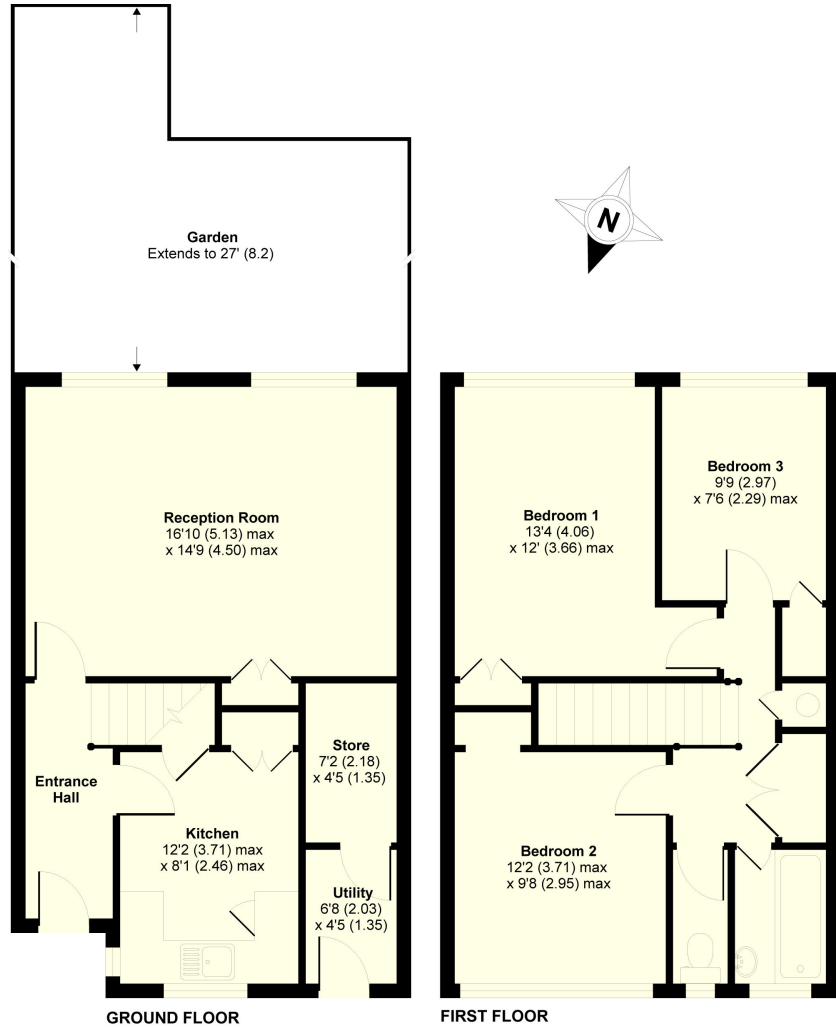

GROSS FLOOR AREA  
INTERNAL 923 SQFT 82.2 SQMETRES

## Lamble Street, London NW5

Whilst every attempt has been made to ensure the accuracy of the floor plans contained here, measurements of doors, windows and rooms are approximate and no responsibility is taken for any error, omission or mis-statement. These plans are for representation purposes only as defined by RICS Code of Measuring Practice and should be used as such by any prospective purchaser. The services, systems and appliances listed in this specification have not been tested by Salter Rex and no guarantee as to their operating ability or their efficiency can be given.

Copyright nichecom.co.uk 2009 Produced for Salter Rex REF : NH095313

## ENERGY PERFORMANCE CHART

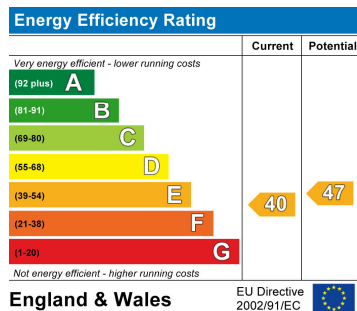

## CONTACT DETAILS

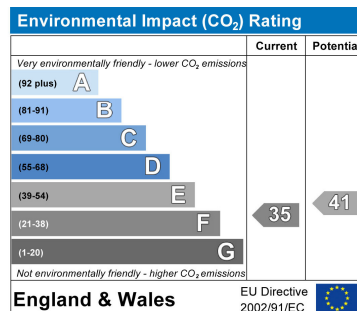

**SALTER REX**  
Chartered Surveyors & Estate Agents

SALTER REX KENTISH TOWN  
CROWN HOUSE  
265-267 KENTISH TOWN ROAD  
LONDON  
NW5 2TP

T 020 7482 4488 F 020 7485 8488

E: [residential@salter-rex.co.uk](mailto:residential@salter-rex.co.uk)

W: [www.salter-rex.co.uk](http://www.salter-rex.co.uk)