

PARK STREET

MAYFAIR W1



Three bedroom apartment (1806 Square Feet)
with two adjoining reception rooms in block
with 24hr Concierge

£2,500,000
SOLE AGENT



T: +44 (0) 20 7493 6935

E: mail@wetherell.co.uk

wetherell.co.uk

102 Mount Street · London · W1K 2TH

Wetherell & Co. (Mayfair) Ltd · Co. Registration No: 2651793





PARK STREET

MAYFAIR W1

Forming part of a block built in 1928-30, with a façade by Sir Edwin Lutyens, New Hereford House is an apartment building which underwent major redevelopment in the late 1990's.

The flat, situated on the south west corner of the 4th floor benefits from 24 hour security and smart common areas, with an entrance foyer furnished by David Linley and features two communicating south facing reception rooms totalling 39 feet in length.

- * Entrance Hall
- * Two Reception Rooms
- * Master Bedroom with En Suite Bathroom
- * Two Guest Bedrooms
- * Bathroom
- * Poggenpohl Kitchen / Breakfast Room
- * Comfort Cooling & Independent Central Heating
- * 1806 Square Feet
- * 24 Hour Porterage
- * Two Passenger Lifts

Tenure: Leasehold, approximately 110 years unexpired

Ground Rent: £200 per annum

Service Charge: Approximately £8,108 per annum,
plus £1,490 contribution to reserve fund

Price: £2,500,000

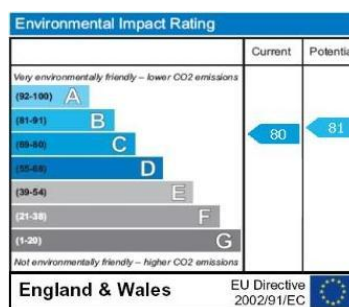
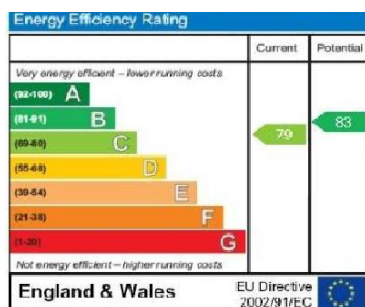

Wetherell & Co have no authority to make or give any representation or warranty whatever in relation to this property. These particulars do not form part of any offer or contract nor be relied upon as statements or representations of fact. All statements contained in these particulars as to this property are made without responsibility on the part of the agent. Any areas, measurements or distances, text, photographs and plans are for guidance only and are not necessarily comprehensive. It should not be assumed that the property has all the necessary planning, building regulation or other consents and Wetherell have not tested any services, equipment or facilities. Purchasers must satisfy themselves by inspection or otherwise. Details Prepared August 2008.

PARK STREET

MAYFAIR W1



New Hereford House,
Park Street, W1
Approx. Gross Internal Area
1806 Sq Ft - 167.78 Sq M

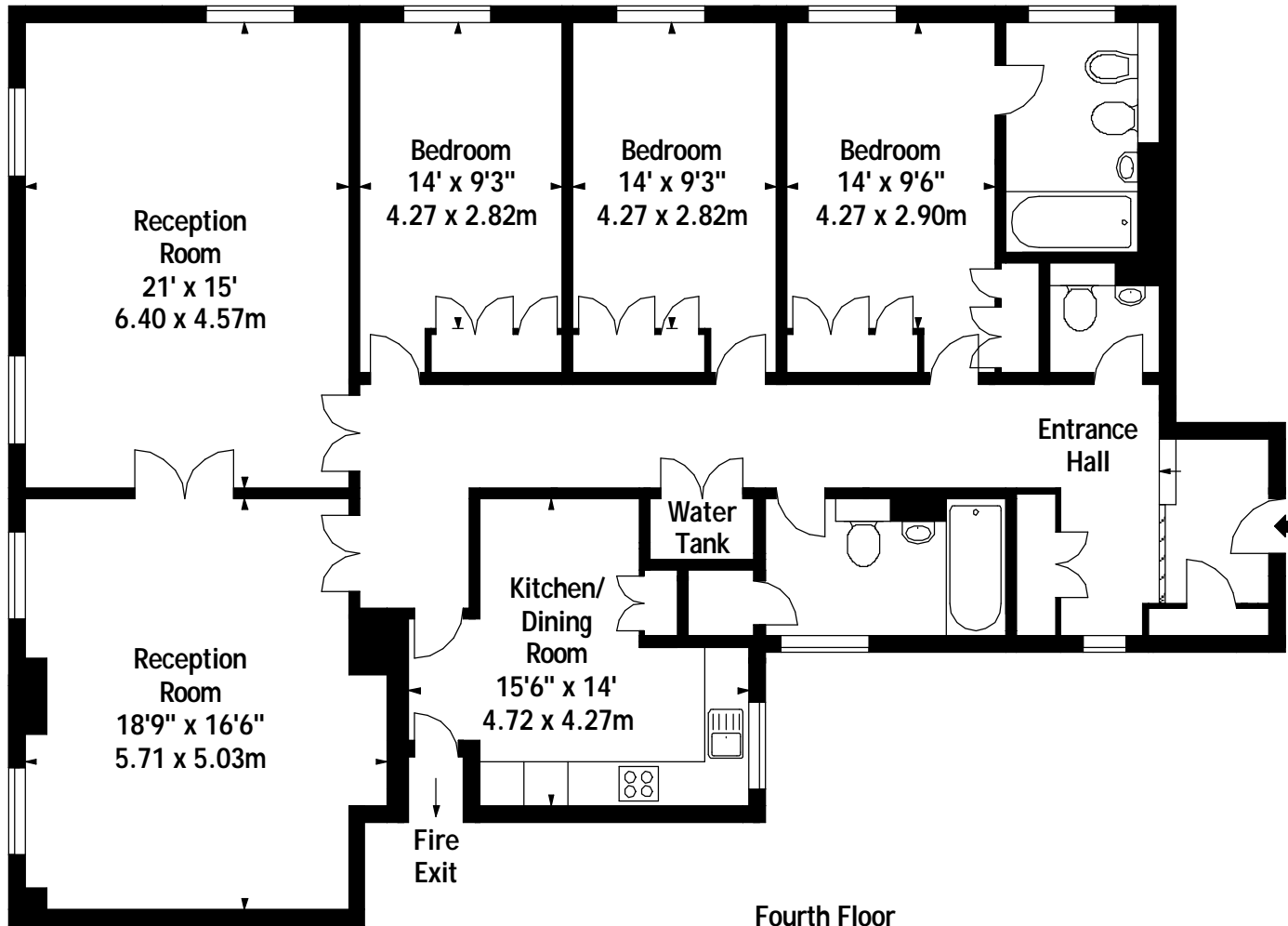

Measured in accordance with RICS guidelines. Every attempt is made to ensure accuracy, however all measurements are approximate. This floor plan is for illustrative purposes only and is not to scale.

© Datography UK Ltd 2008

Photographs * Floorplans * Virtual Tours
Tel: 08707 66 30 30 www.datography.com