

DRAFT

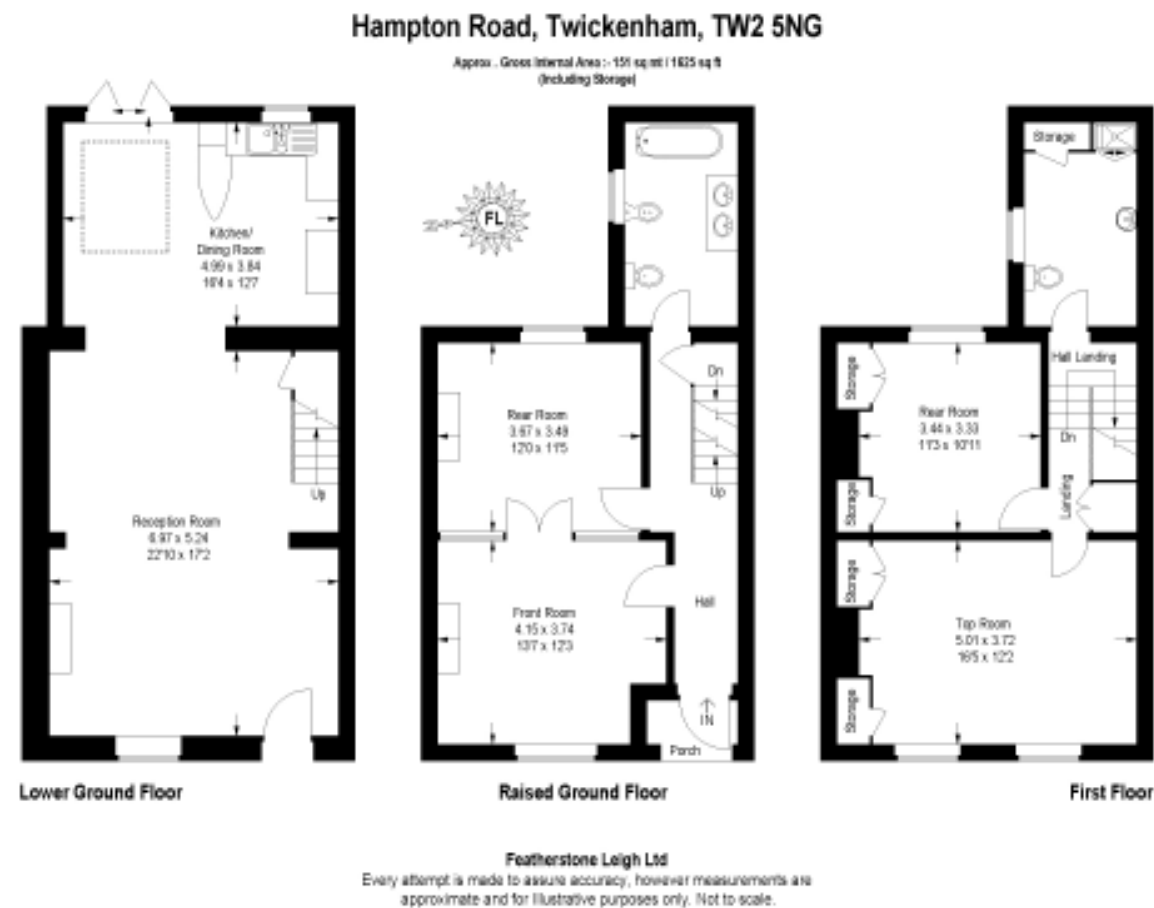

Hampton Road, Twickenham

A most impressive Regency style semi-detached Period house, conveniently located for both Strawberry Hill and Fulwell mainline stations as well as many local amenities. The accommodation comprises of a stunning and surprisingly light family room/kitchen/dining room to the lower ground floor; two adjoining rooms and luxury bathroom to the raised ground floor and two large bedrooms with a spacious shower room to the top floor. Outside there is a private landscaped garden and off-street parking. Hampton Road is situated within easy reach of Teddington, Strawberry Hill and Twickenham town centres. No chain.

Price: £565,000 (Freehold)

VIEWING BY APPOINTMENT WITH THE VENDOR'S AGENT
FEATHERSTONE LEIGH 020 8744 0595

12 York St, Twickenham, Middlesex, TW1 3LD

